

Parts Guide for Fontaine® No-Slack® H7 Series Fifth Wheels

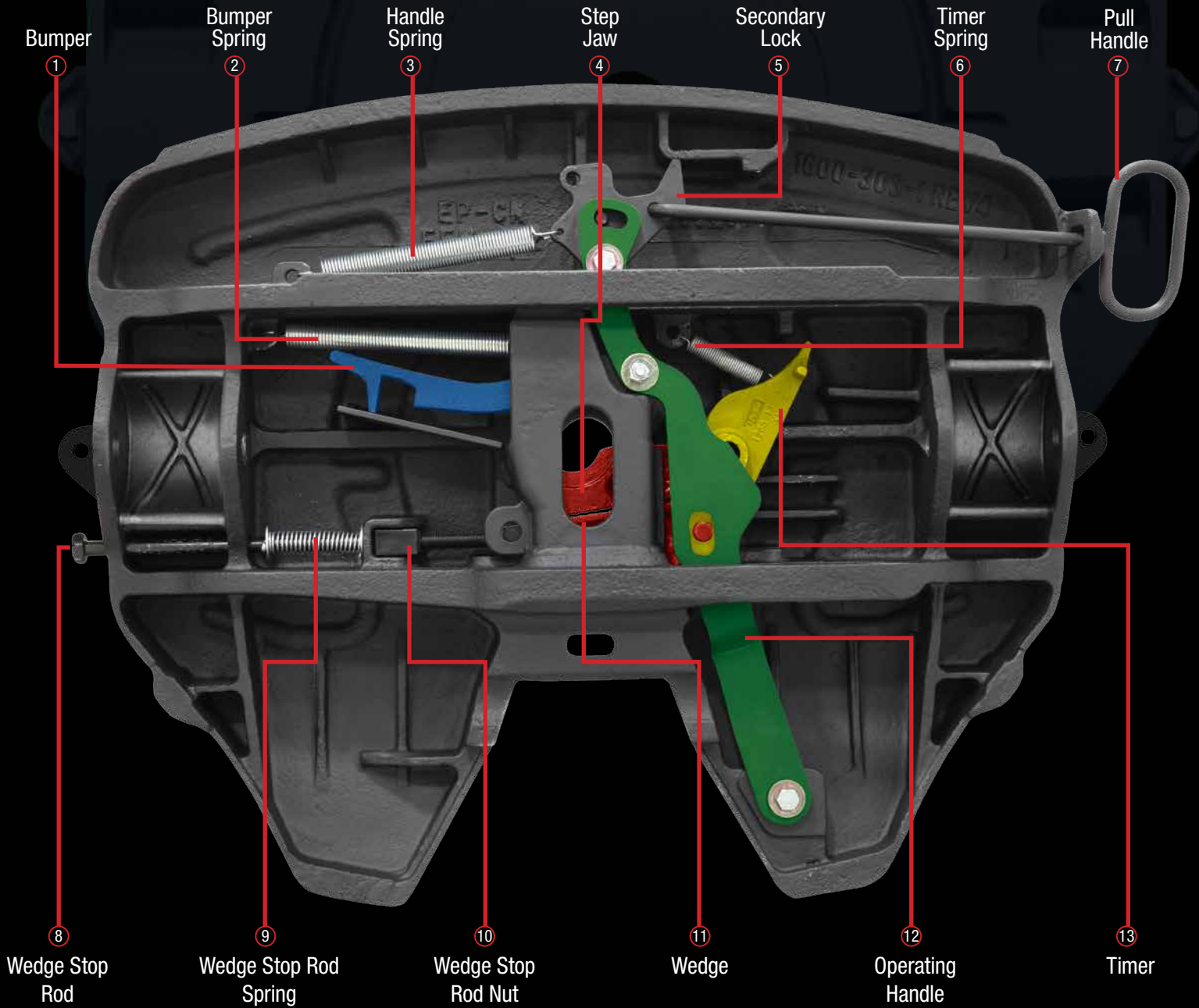

SLTPLH7 model shown

Description	Part Number	Fits	Weight (lbs)	Contains
Pull Handle	KIT-PUL-H7	H7	2.2	⑦
Operating Handle	KIT-OPR-H7	H7	5.2	⑫
Timer Kit	KIT-TMR-6000*	6000,7000,7000CC,NT,H7	3.4	⑬⑥
Adjustment Rod Kit	KIT-ROD-1108	6000,7000,7000CC,NT,H7	1.5	⑧⑨⑩
Bumper Kit	KIT-BPR-6000*	6000,7000,7000CC,NT,H7	3.7	①②
Spring Kit	KIT-SPRING	6000,7000,7000CC,NT,H7	1.1	②③⑥
Replacement top plate	SLTPLH7	5092,X5092,H7	245	Complete

Part numbers that start with "KIT" include installation hardware.

* Part can be a L (left) or R (right).



Repair

Repair kit (KIT-RPR-6000L)

Item	Description	Qty.
6	Bumper spring	1
7	Handle spring	1
37	Timer spring	1
21	Step jaw	1
22	Wedge	1
10	Bushing, 7/16"	1
15	Bushing, 5/16"	1
19	Bushing, 1 1/4"	1
12	Hex lock nut, 1/2" - 13	3

Spring kit (KIT-SPRING)

6	Bumper spring	1
7	Handle spring	1
17	Timer spring	1

Wedge-stop rod kit (KIT-ROD-1108)

1	Wedge-stop rod nut	1
2	Flat washer, 5/8" I.D.	2
3	Wedge-stop rod spring	1
4	Wedge-stop rod	1
5	Cotter pin, 3/16" x 1"	1

Secondary lock kit (KIT-LAT-6000L)

7	Handle spring	1
8	Hex head bolt, 1/2" - 13	1
9	Flat washer, 1/2" I.D.	2
10	Bushing, 7/16"	1
11	Secondary lock	1
12	Hex lock nut, 1/2" - 13	1
5	Cotter pin, 3/16" x 1"	1

Pull handle kit (KITPULH7)

13	Heavy Duty Pull Handle	1
12	Hex lock nut, 1/2" - 13	1

Bumper kit (KIT-BPR-6000)

12	Hex lock nut, 1/2" - 13	1
14	Flat washer, 1/2" I.D.	2
15	Bushing	1
8	Hex head bolt, 1/2" - 13	1
16	Bumper	1
6	Bumper spring	1

Timer kit (KIT-TMR-6000L)

17	Timer spring	1
18	Timer	1
12	Hex lock nut, 1/2" - 13	1
5	Hair pin cotter	1

Operating handle kit (KITOPRH7)

10	Bushing, 7/16"	1
15	Bushing, 5/16"	1
19	Bushing, 9/16"	1
12	Hex lock nut, 1/2" - 13	3
9	Flat washer, 1/2" I.D.	2
8	Hex head bolt, 1/2" - 13	1
20	Operating Handle	1
5	Hair pin cotter	1

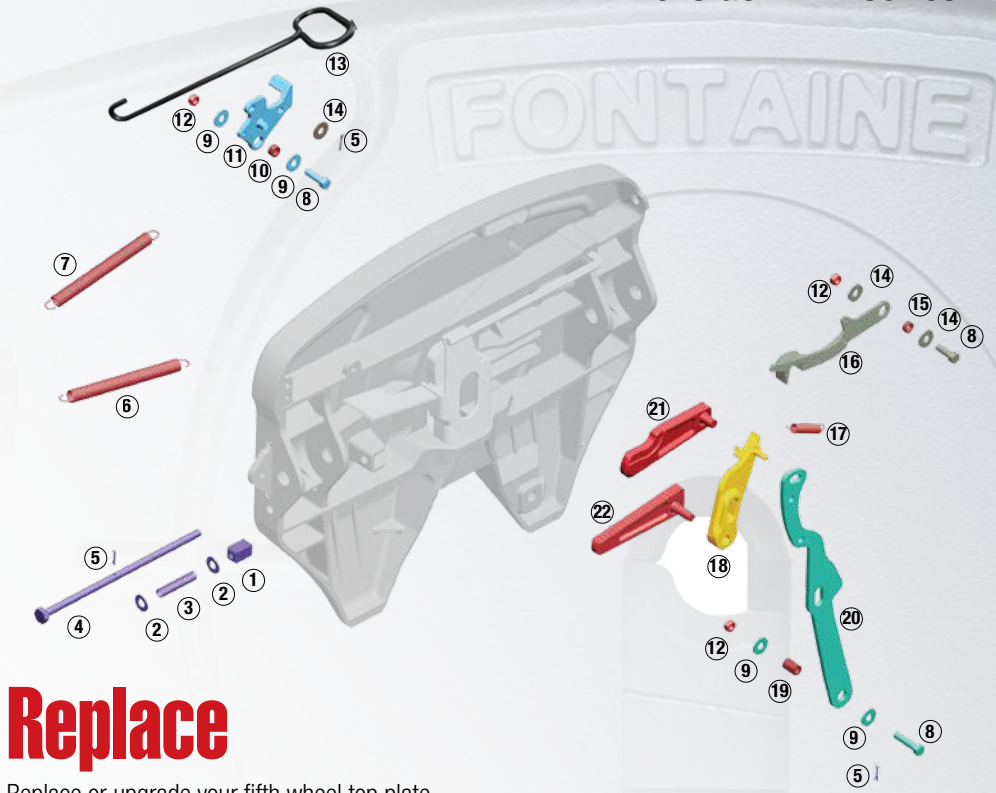

Replace

Replace or upgrade your fifth wheel top plate.

H7 is the recommended replacement for H5092 and X5092



H7 Heavy Duty
SLTPLH7 (Driver side release)

H7 Repair Kits

Operating handle kit (KITOPRH7)

Item	Qty.
Bushing, 7/16"	1
Bushing, 5/16"	1
Bushing, 9/16"	1
Hex lock nut, 1/2" - 13	3
Flat washer, 1/2" I.D.	2
Hex head bolt, 1/2" - 13	1
Heavy Duty Operating Handle	1
Hair pin cotter	1

Pull handle kit (KITPULH7)

Item	Qty.
Heavy Duty Pull Handle	1
Hex lock nut, 1/2" - 13	1

With the exception of the two kits above, H7 uses same kits as 6000/7000/7000CC top plates

Bracket Pin and Bushing Kits

Part number:
KIT-PIN-191



Use for AWB, MWS, PSA or PS5. For AWX mounts use KIT-PIN-XHD.

Part number:
BSH-150



Recommended bushings for all H7 mounts.

